

In the box

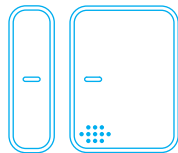

Door Sensor

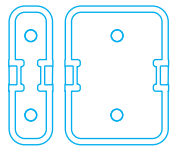

Mounting Plate

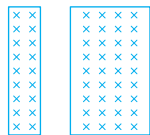

Adhesive Strips

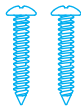

Screws

1x CR-2450 Battery
(pre-installed)

1 Open hub to initiate pairing with device.

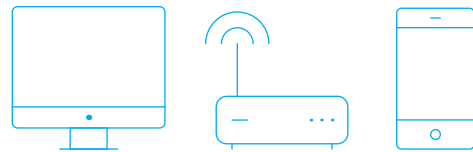

2 Remove "Remove to Pair" tab to begin the pairing process.

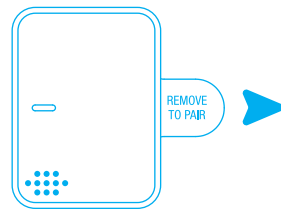

Some hubs and controllers require additional steps such as naming the device.

3 LED Patterns.



Searching for networks



Joining Successful

4 Installation

- a) Place the sensor's mounting clip on the door frame.
- b) Attach mounts using included screws, then snap the sensor and magnet into their corresponding mounts.

5 Optimal installation.

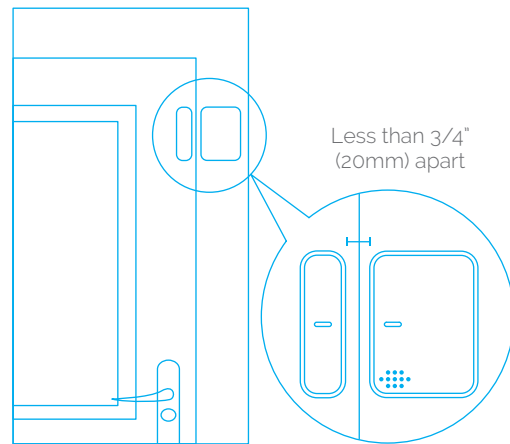

Factory Reset

Eject battery tray. Next, press and hold the reset button on side of sensor while sliding battery tray back into device. Once the LED turns blue, release button to factory reset device. Repeat the "Getting Started" steps to rejoin the ZigBee network.

Support

Web: www.centralite.com
Phone: +1-877-466-5483

Hi!
I'm a Door Sensor.

Let's get started.

